



Please read through these instructions carefully prior to installation.



Video instructions  
rammount.com/un12

## Parts Index

\*not to scale

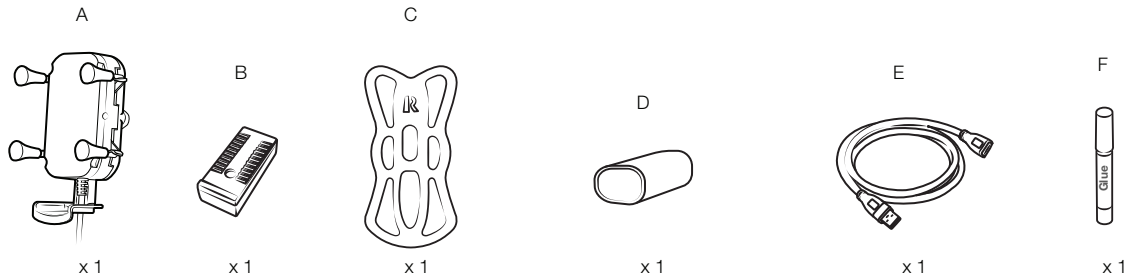

### LED Indicator

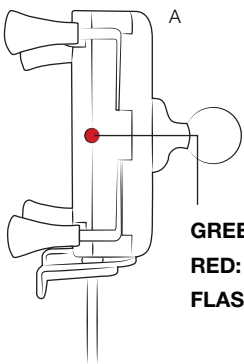

**GREEN:** Phone is charging  
**RED:** Holder detects power  
**FLASHING RED:** Error

### Support Leg

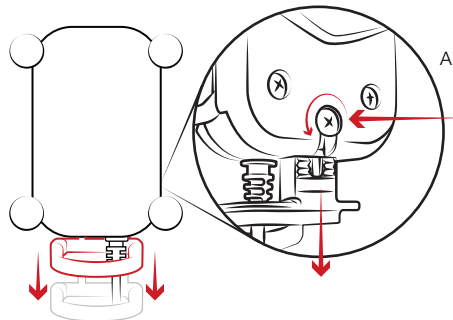

Insert and secure leg cover (B) when not using the support leg

### Phone Placement



Phone does not have to be directly in the middle to detect the wireless charger

### X-Grip<sup>®</sup> Cap Glue

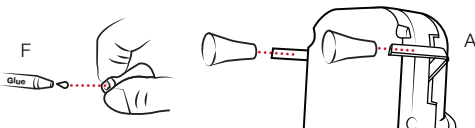

### Cable Management

Slip cable tubing (C) over USB 2.0 connector. Insert the USB 2.0 extension cable receiver into the open end of the tubing and push through to connect cable receiver to male end. Secure the two connectors with 4 wire ties to desired surface.

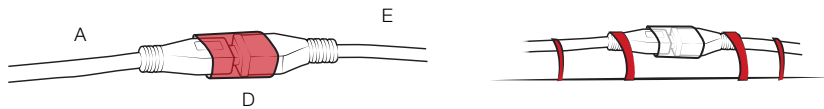

**IMPORTANT:** For open cockpit applications (i.e. motorcycles, ATV's, boats, etc.) apply silicone grease to the USB Type-A male & female connector to protect the connections and prevent corrosion. Failure to do so will void warranty.



### Optional Tether

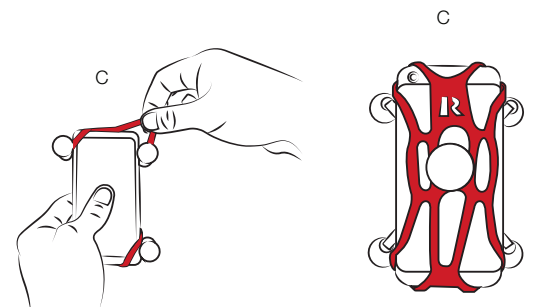

This electronic product is covered under a 1-year warranty; proof of purchase required. Warranty does not cover normal wear and tear over the lifetime of the product. There are no upgrades; only defective components will be replaced.

RMR-INS-UN12W



### Safety Precaution

Do not install this product near or over an airbag deployment area or in a location that obstructs the driver's vision or interferes with vehicle operation. National Products, Inc does not assume responsibility or liability for any such personal injury, death or property damage.